



Poppy Fields Kiondroghad Road, Andreas, Isle Of Man, IM7 3EL
£439,950

- Set back from Kiondroghad Road, Andreas, with a generous driveway for several vehicles and a garage
- Three good-sized bedrooms, including a principal bedroom with en suite, plus a family bathroom
- Spacious entrance hall leading to an open plan living and dining room with double aspect windows
- Pleasant front lawn and rear garden enjoying open field views and a tranquil outlook
- Charming kitchen and conservatory providing flexible living space



Poppy Fields, located on Kiondroghad Road in the popular village of Andreas, is a delightful family home nicely set back from the roadside, offering both privacy and a peaceful setting.

A good-sized driveway provides parking for several vehicles and leads to a garage, while a pleasant front lawn enhances the home's kerb appeal. Inside, a spacious entrance hall creates a welcoming first impression and sets the tone for the accommodation that follows.

The open plan living and dining room is a real highlight, featuring double aspect windows that flood the space with natural daylight, making it ideal for both everyday living and entertaining. A charming kitchen sits at the heart of the home, complemented by a conservatory which offers a lovely additional reception space overlooking the garden.

The property offers three good-sized bedrooms, with the principal bedroom benefiting from an en suite shower room. A well-appointed family bathroom completes the internal accommodation, which extends to approximately 1,597 square feet.

Externally, the rear garden is a standout feature, enjoying open field views that provide a wonderful sense of space and tranquillity—perfect for relaxing or entertaining while taking in the surrounding countryside.

Poppy Fields combines comfortable living with a peaceful rural outlook, making it an excellent choice for those seeking a well-proportioned home in a desirable village location.













Poppy Fields Kiondroghad Road, Andreas, Isle Of Man, IM7 3EL



GROUND FLOOR
1597 sq.ft. (148.4 sq.m.) approx.

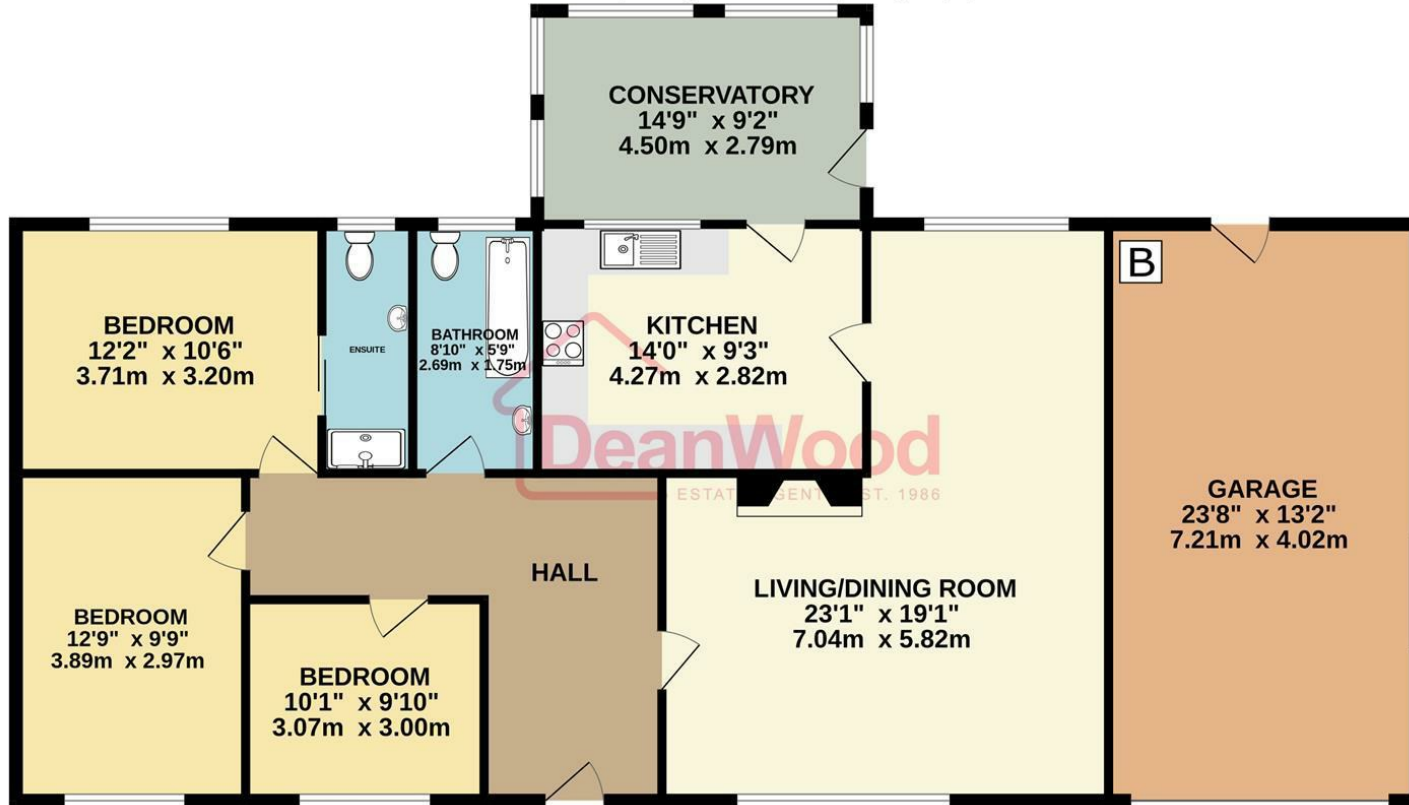

TOTAL FLOOR AREA : 1597 sq.ft. (148.4 sq.m.) approx.
Not to scale-for identification purposes only
Made with Metropix ©2026



DOUGLAS

37 VICTORIA STREET
DOUGLAS
ISLE OF MAN IM1 2LF

T 01624 620606
F 01624 677363
E info@deanwood.co.im

CASTLETOWN

COMPTON HOUSE
9 CASTLE STREET CASTLETOWN
ISLE OF MAN IM9 1LF

T 01624 825995
F 01624 825996
E castletown@deanwood.co.im

RAMSEY

LEZAYRE HOUSE
87 PARLIAMENT STREET
RAMSEY ISLE OF MAN IM8 1AQ

T 01624 816111
F 01624 816588
E ramsey@deanwood.co.im

These particulars are for information purposes only. They do not constitute or form any contract nor should any statement contained herein be relied upon as a representation of fact. Neither the vendor nor DeanWood Agencies Limited ('the firm'), nor any officer or employee of the firm accept liability or responsibility for any statement contained herein. The vendor does not by these particulars, nor does the firm, nor does any officer or any employee of the firm have any authority to make or give any representation or warranty whatsoever as regards the property or otherwise. It is the sole responsibility of any person interested in the property described in these particulars to make all proper enquiries and searches to verify the description of the property and all other particulars herein.

FOR MORE PROPERTIES VISIT OUR WEBSITE @ deanwood.im